

	D	N	S	E	W
S. 69. E.	87.5		31.3	81.7	
N. 66. E.	28.8	11.7		26.3	
N. 74 3/4 W	87.	22.9			83.9
N 38 W	63.5	50.0			39.1
S 52 1/2 W	47.		28.6		37.3
S 42 E	48.5		36.0	32.4	
S 47 3/4 W	42.		28.2		31.1
S 11 W	13.5		13.2		2.5
S 76 1/2 E	37.5		8.7	36.5	
N 15 1/2 E	63.7	61.4		17.0	
		146.0	146.0	193.9	193.9

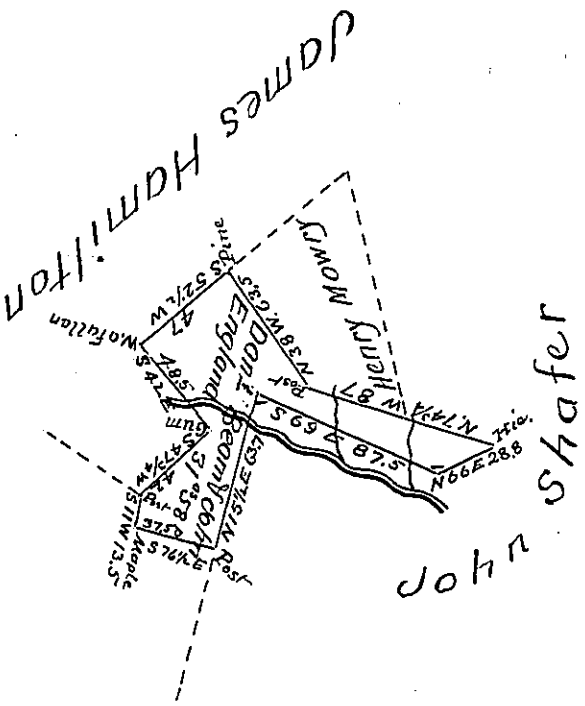

Situate in Providence Township Bedford County Con-
 taining thirty one acres fifty eight perches and al-
 lowance of Six p. Cent for Roads &c. Surveyed the 15th
 September 1841 on Warrant dated the 4th September
 1839 granted to Daniel Beam and John England
 for thirty one acres one hundred and thirty perches &c-

Michael Reed D.S.

To Jacob Sallade Esq^r
 Surveyor General

IN TESTIMONY that the above is a copy of the original remaining on file in
 the Department of Internal Affairs of Pennsylvania, made
 conformably to an Act of Assembly approved the 16th day of
 February, 1833, I have hereunto set my Hand and caused
 the Seal of said Department to be affixed at Harrisburg,
 this twenty eighth day of March 1904.

Isaac B. Brown
 Secretary of Internal Affairs.